

SETUP GUIDE

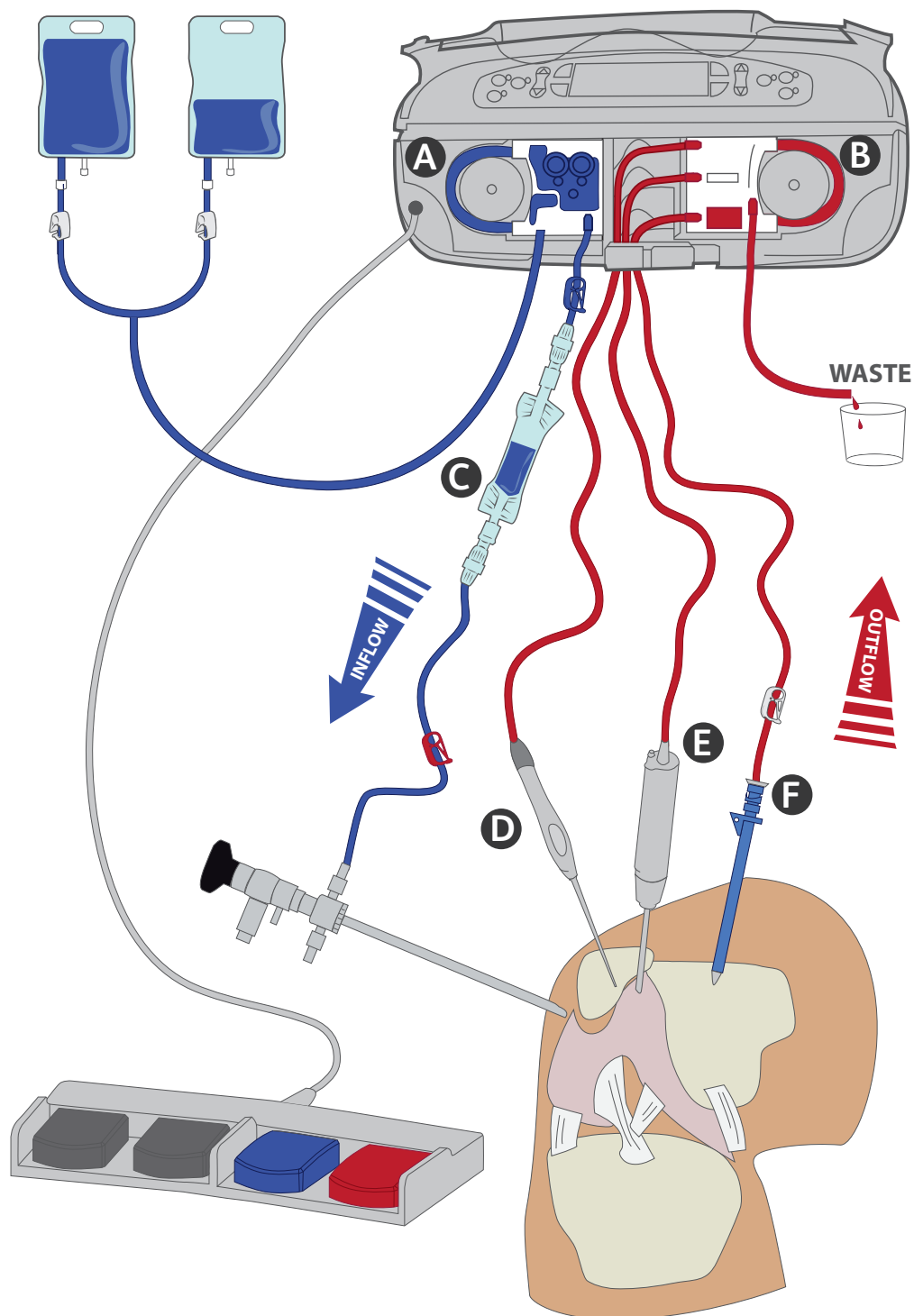

- A** DAY CASSETTE
- B** PATIENT CASSETTE
- C** SINGLE

- D** RF PROBE
- E** SHAVER
- F** OUTFLOW CANNULA

SETUP GUIDE

Double® Pump RF can be connected to a RF system through a an Interface Cable (A-series), a Shaver through either an Interface Box (B-Series) or an Interface Cable (C-Series). The Interface Box is used when the Shaver is controlled by the handpiece, the Interface Cable is used when the Shaver is controlled by the foot control.

SHAVER CONTROLLED BY FOOT CONTROL - INTERFACE CABLE

① Double® Pump RF	④ RF Generator
② Power Cable	⑤ RF Probe
③ Pump Foot Control	⑥ RF Interface cable
a) Shaver Reverse	⑦ RF Foot Control
b) Shaver Forward	⑧ Shaver Console
c) Cannula	⑨ Shaver Handpiece
d) Rinse	⑩ Shaver Interface Cable

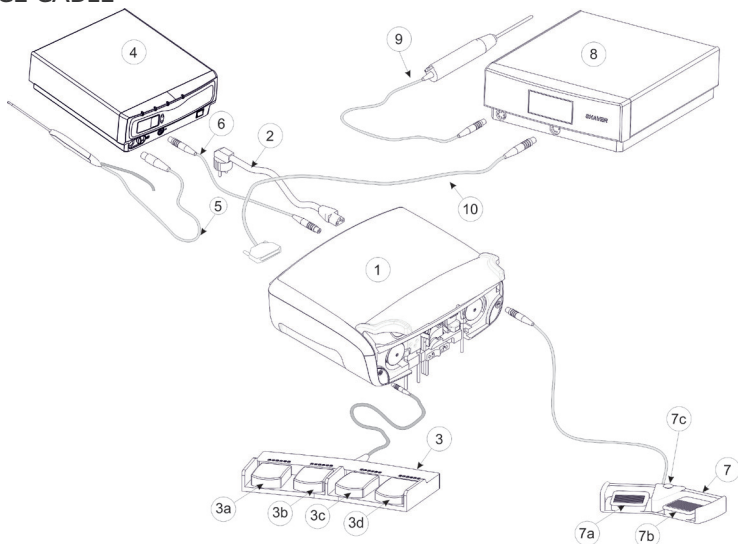

SHAVER CONTROLLED BY HANDPIECE - INTERFACE BOX

① Double® Pump RF	④ RF Generator
② Power Cable	⑤ RF Probe
③ Pump Foot Control	⑥ RF Interface cable
a) Cannula	⑦ RF Foot Control
b) Rinse	⑧ Shaver Console
	⑨ Shaver Handpiece
	⑩ Shaver Interface Box

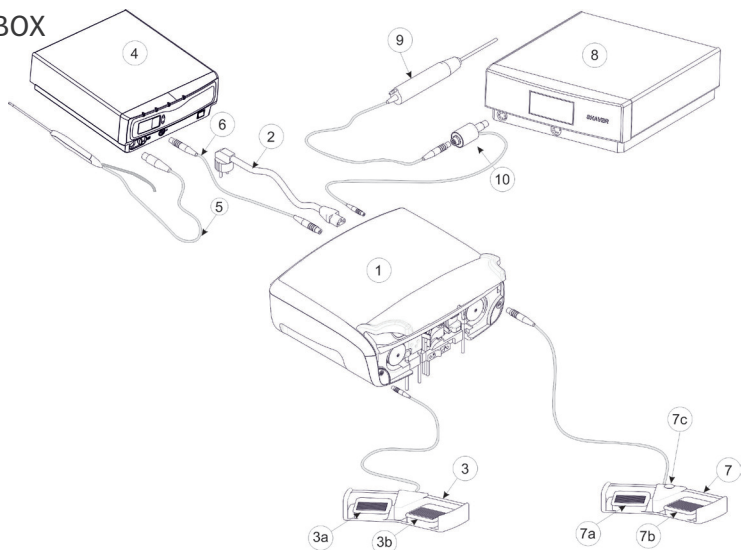

Interface Box		Interface Cable		Shaver
Article number	Description	Article number	Description	
1407200	B1	1407250	C1	Conmed-Linvatec Advantage D 3000
1407201	B2	1407251	C2	S&N Dyonics Power, Power II
1407204	B5	Does not exist		Stryker TPS 12K B/BF, Stryker Core, Biomet PowerTek II Plus
1407205	B6	1407254	C5	Arthrex APS II
1407205	B6	1407255	C6	FMS Duo+, Atlantech Revolution
Pending validation		1497257	C8	Eberle
Pending validation		1407260	C10	Conmed-Linvatec Apex
Pending validation		1407262	C11	Ackerman Shaver 16-2050
1407206	B7	1407263	C14	S&N Dyonics EP-1
C15 acts like both B & C-cable		1407264	C15	Biomet PowerTek II Plus
1407207	B8	1407265	C16	Tekno TM 900
		Interface Cable		RF system
		Article number	Description	
		1402008	A1	Arthrocare Atlas, Quantum 1 & 2

6000007 Rev.01 2012-05



Medical Vision AB
Hästholsmvägen 32
SE-131 30 Nacka
Sweden

Phone: +46 (0)8 452 49 50
Fax: +46 (0)8 452 49 59
www.medicalvision.se
info@medicalvision.se



0413

Medical Vision®
Technology at your service